

HEIGHT ADJUSTABLE FRAME

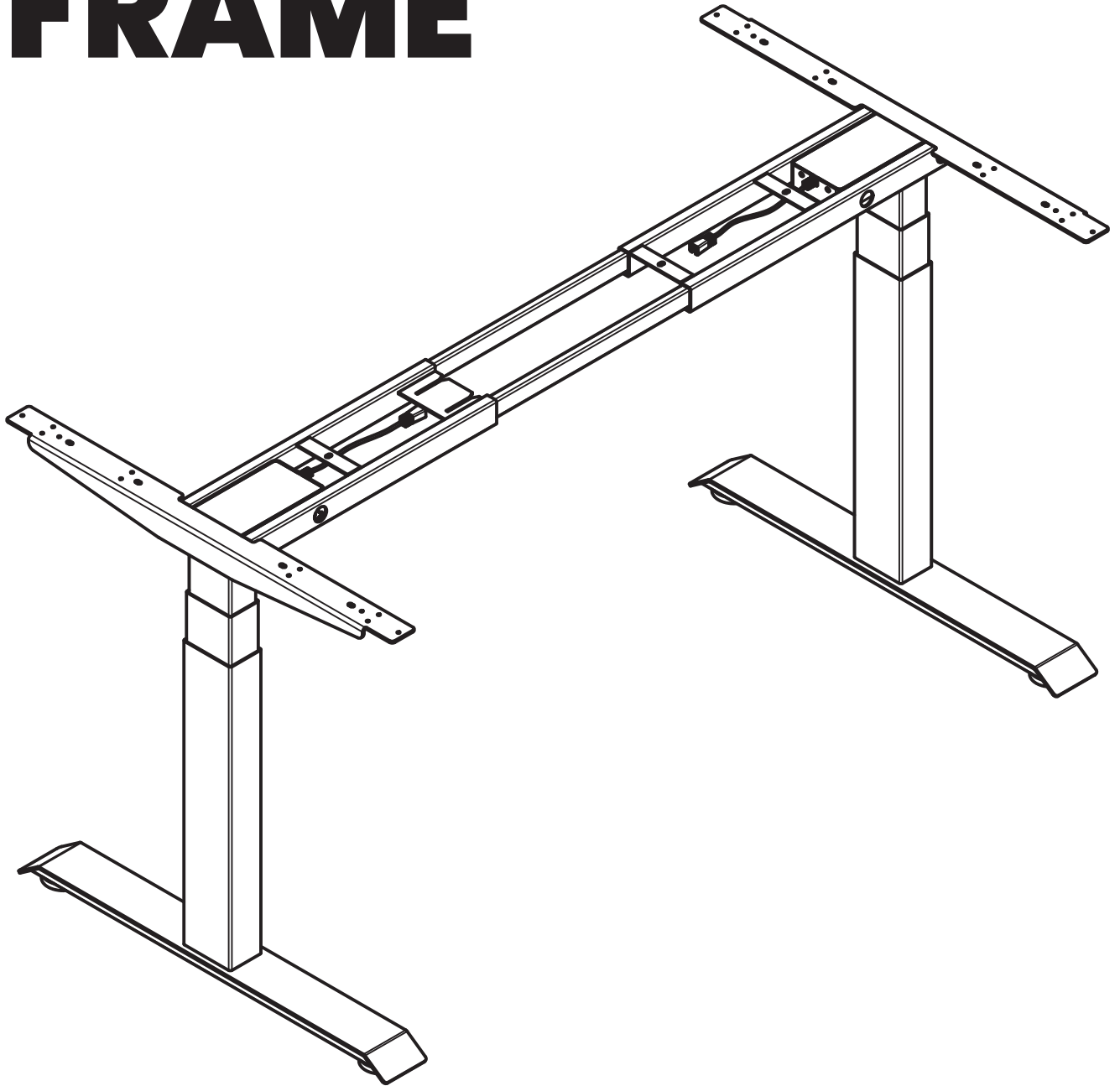

ErgoHide

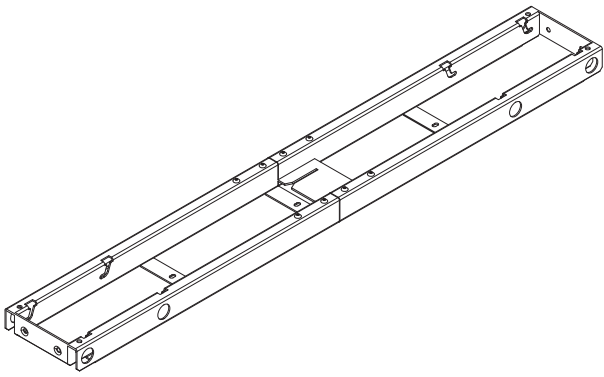

1x

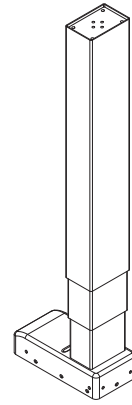

2x

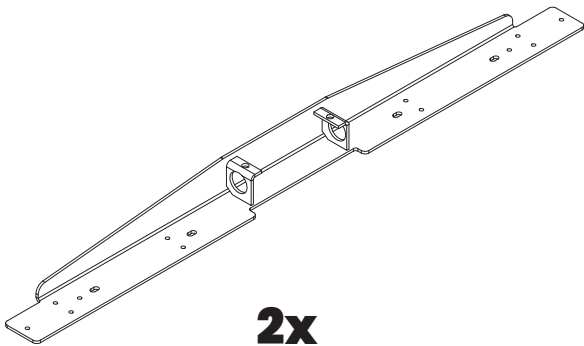

2x

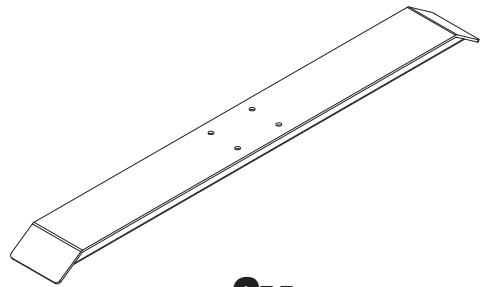

2x

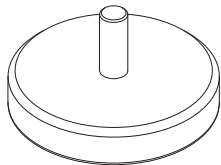

4x

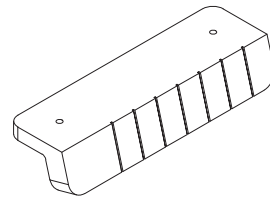

1x

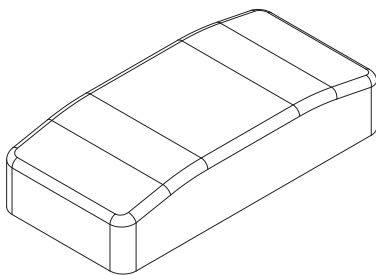

1x

ErgoHide

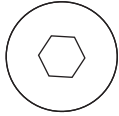
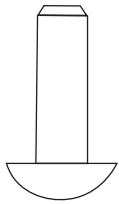

M6x16

12x

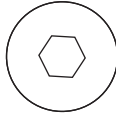
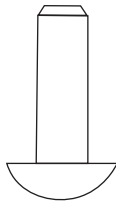

M5x16

11x

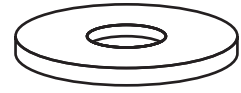

Rubber pad

11x

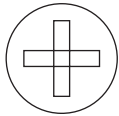
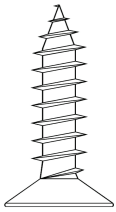

ST4x20

2x

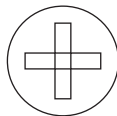

ST4x16

2x

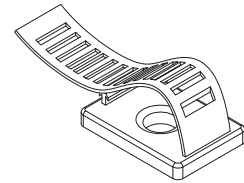

Cable clip

2x

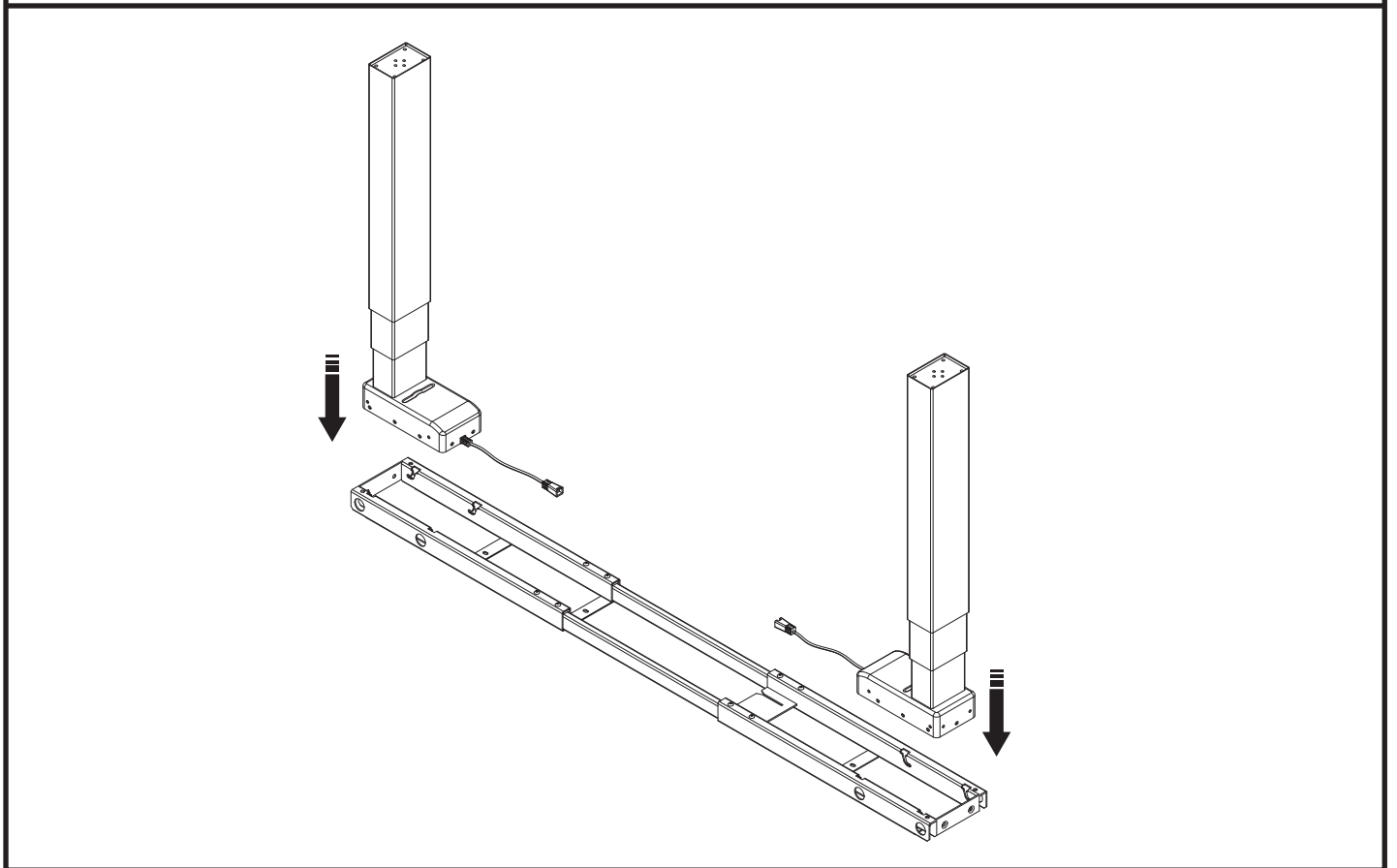
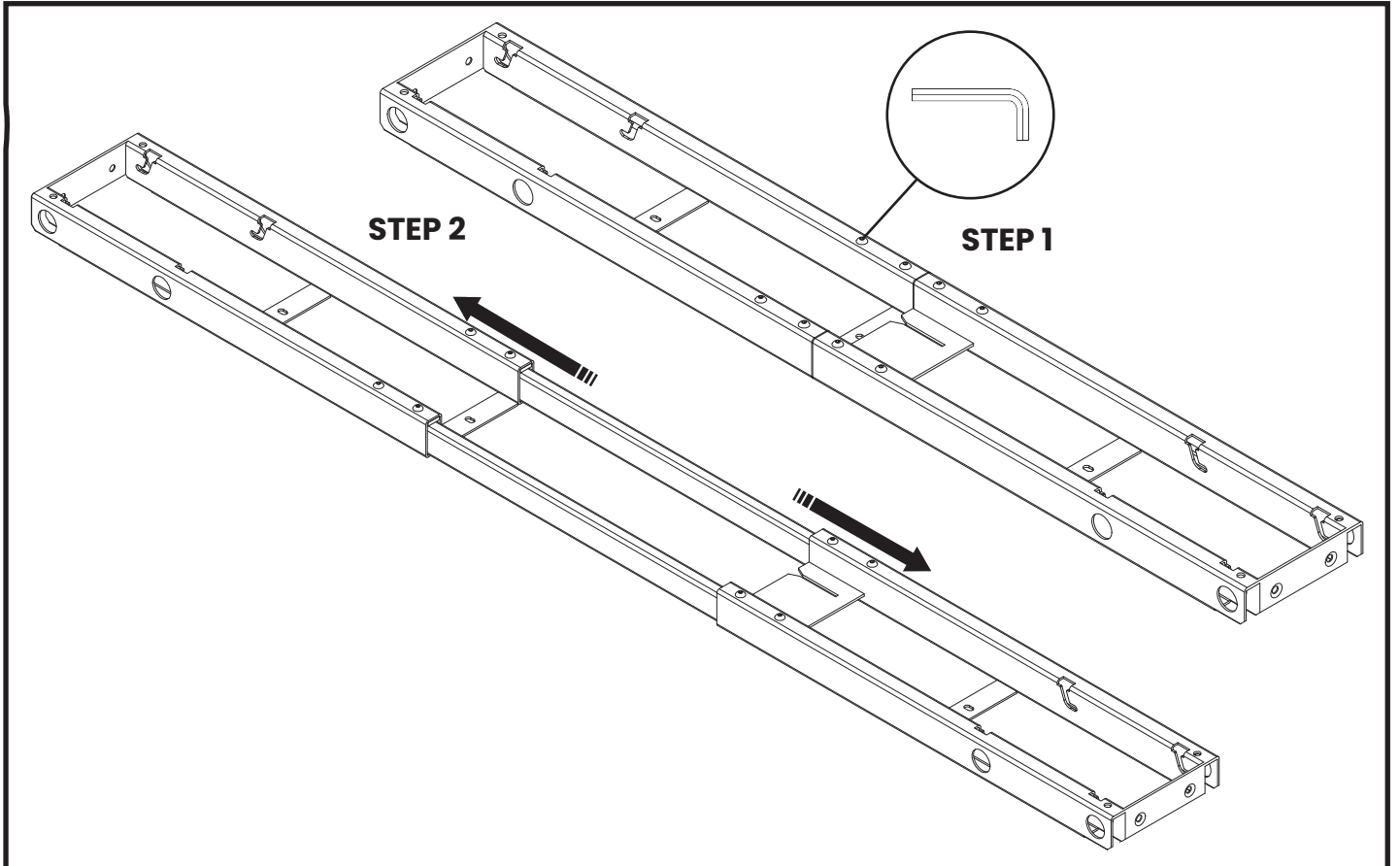

ErgoHide

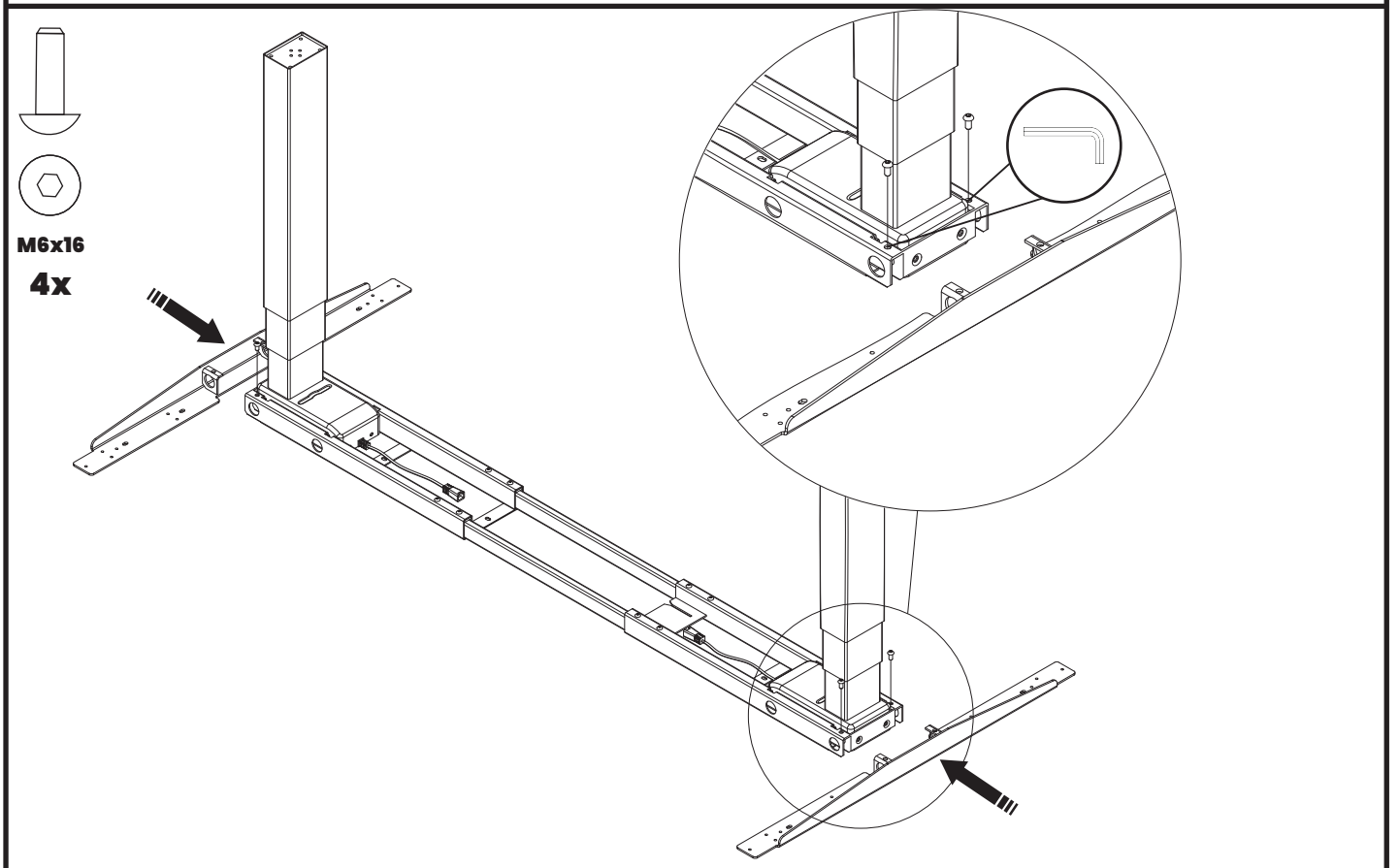
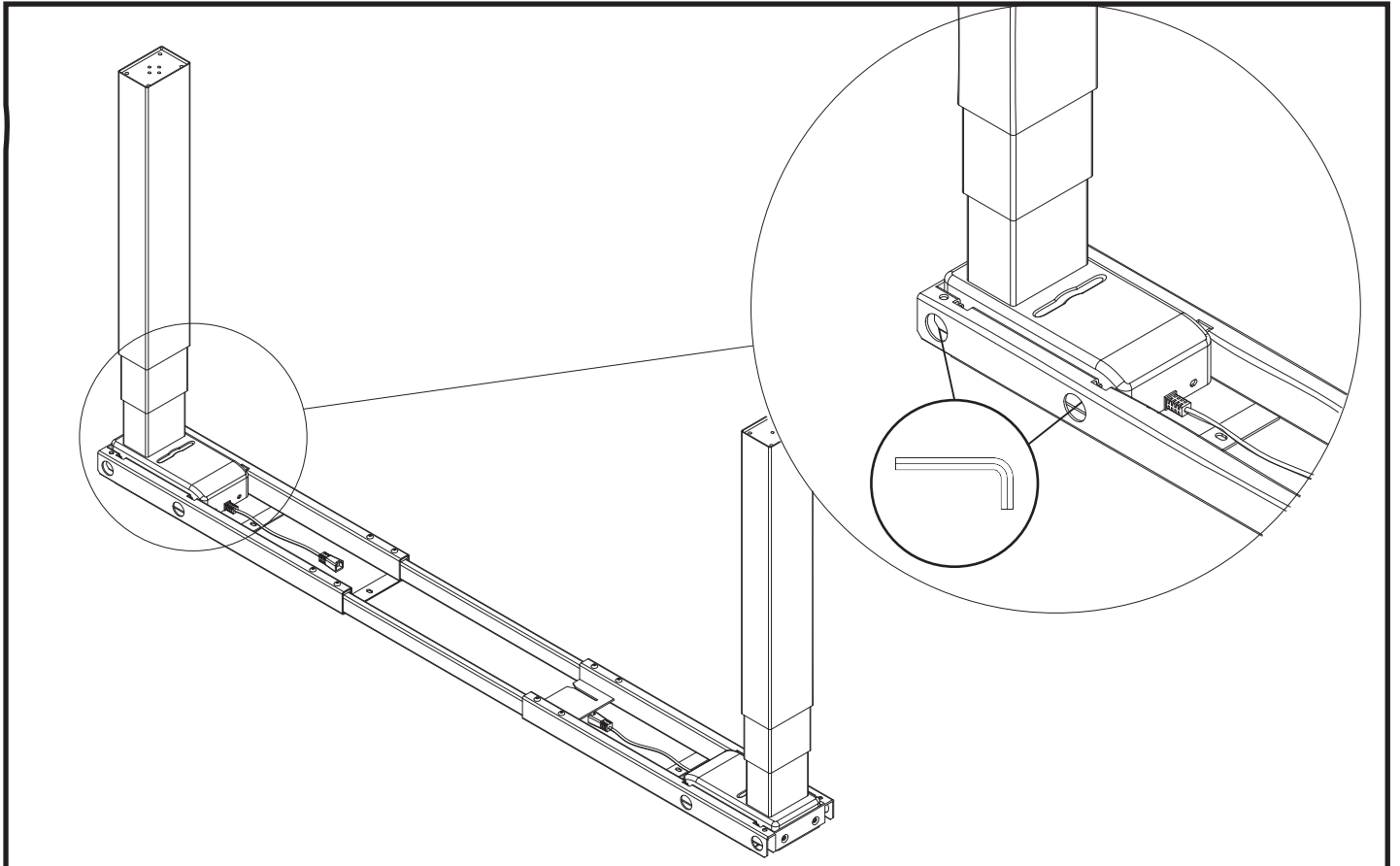

ErgoHide

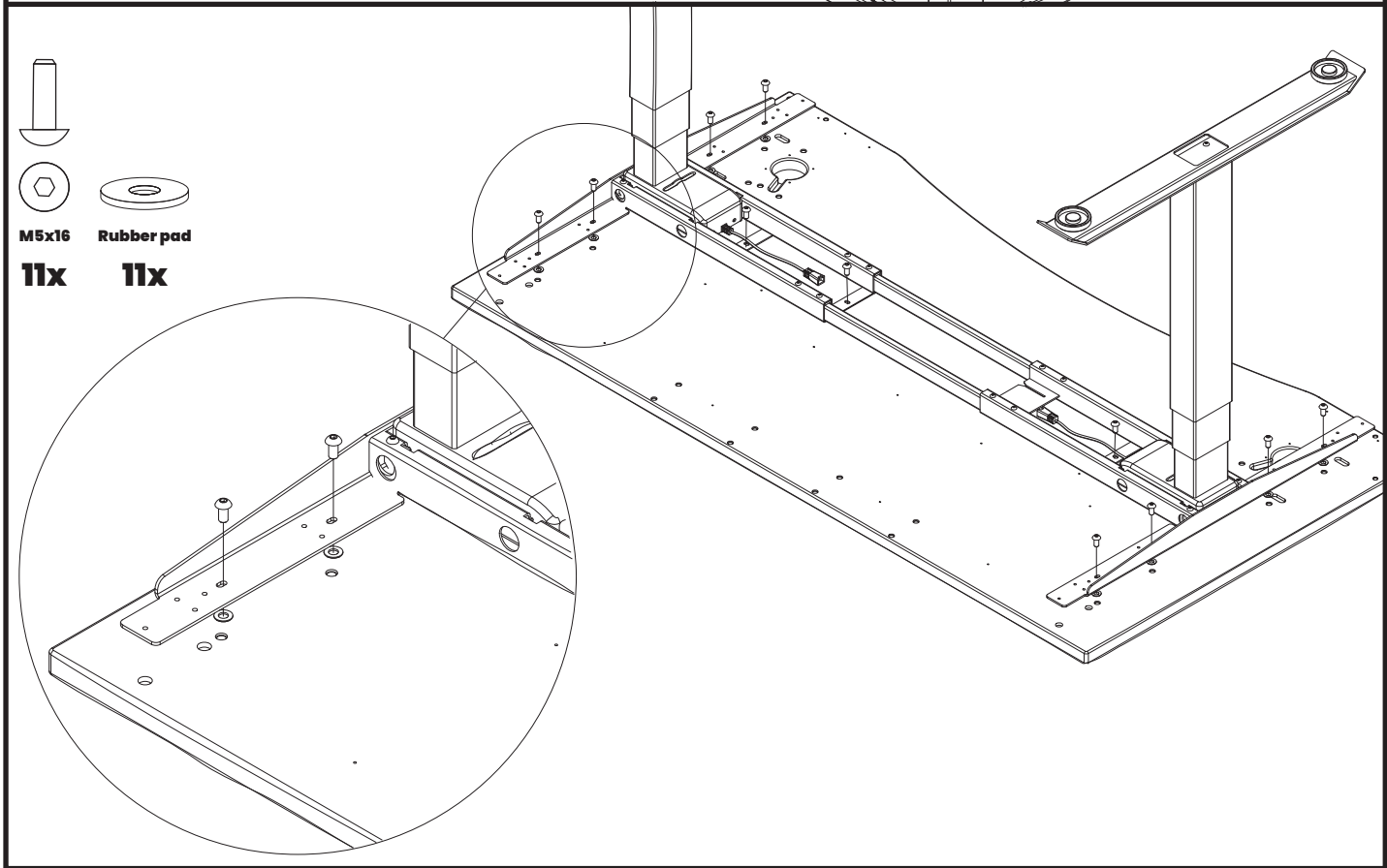
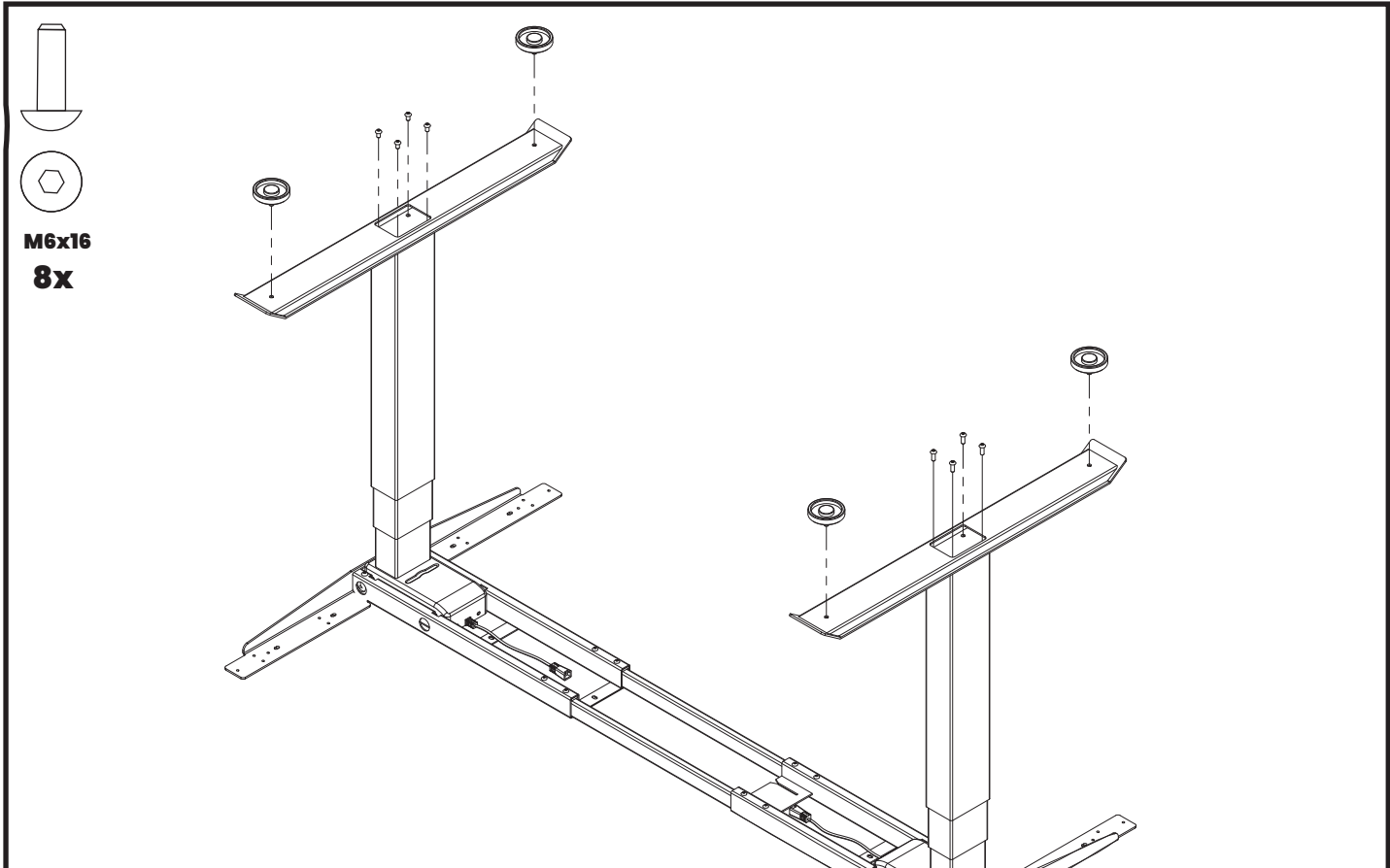

ErgoHide

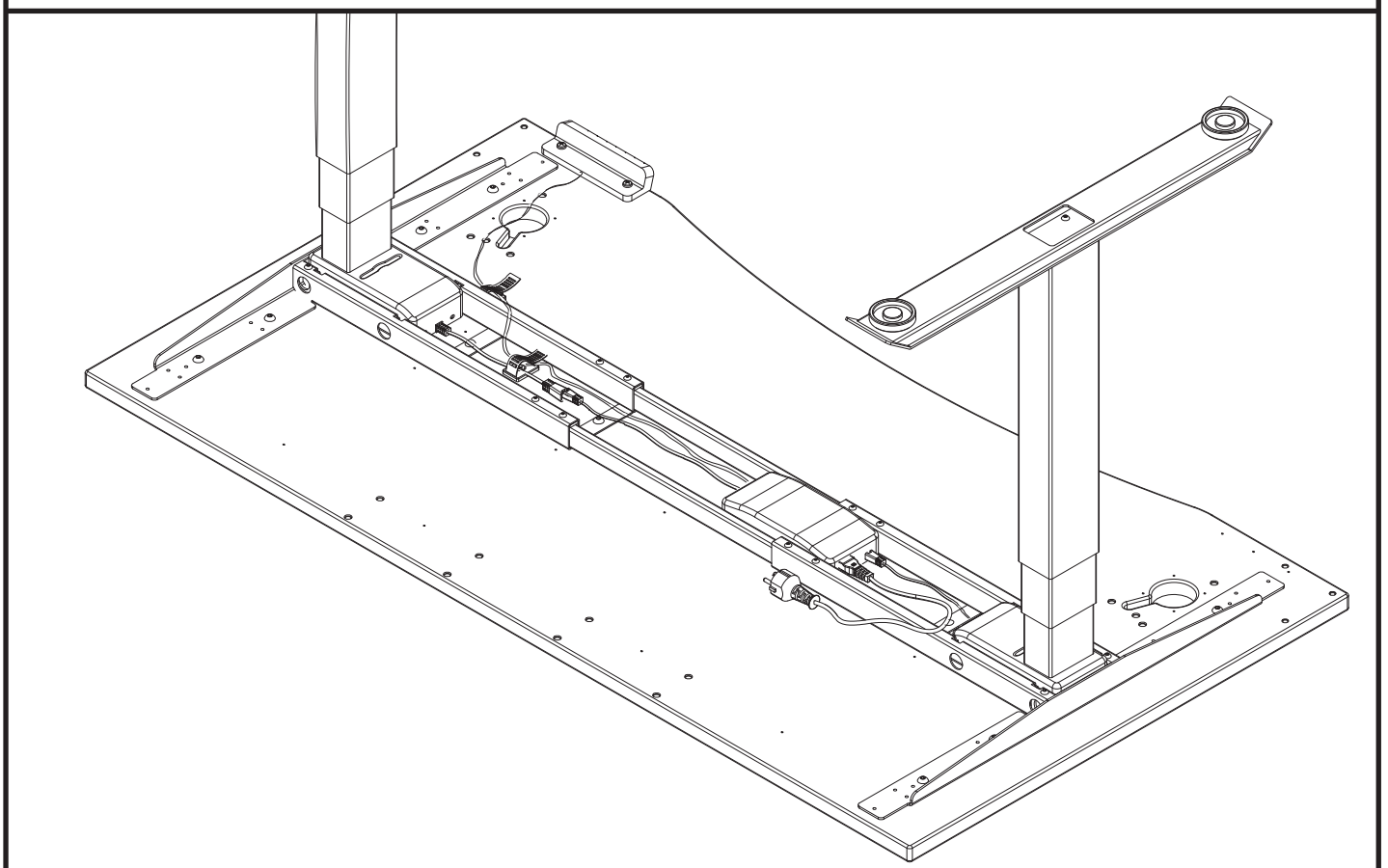
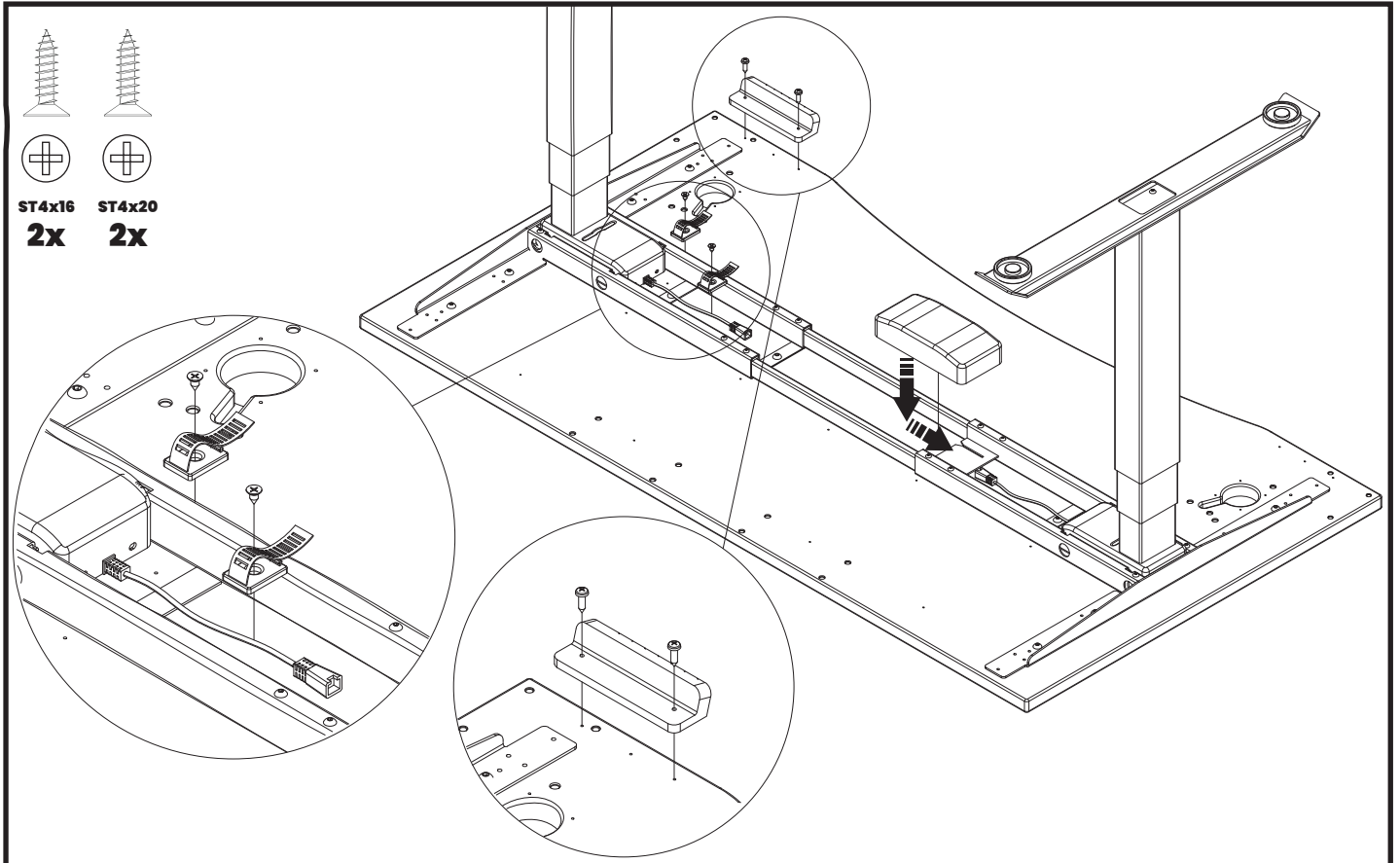

ErgoHide

Lifting column

Lifting column

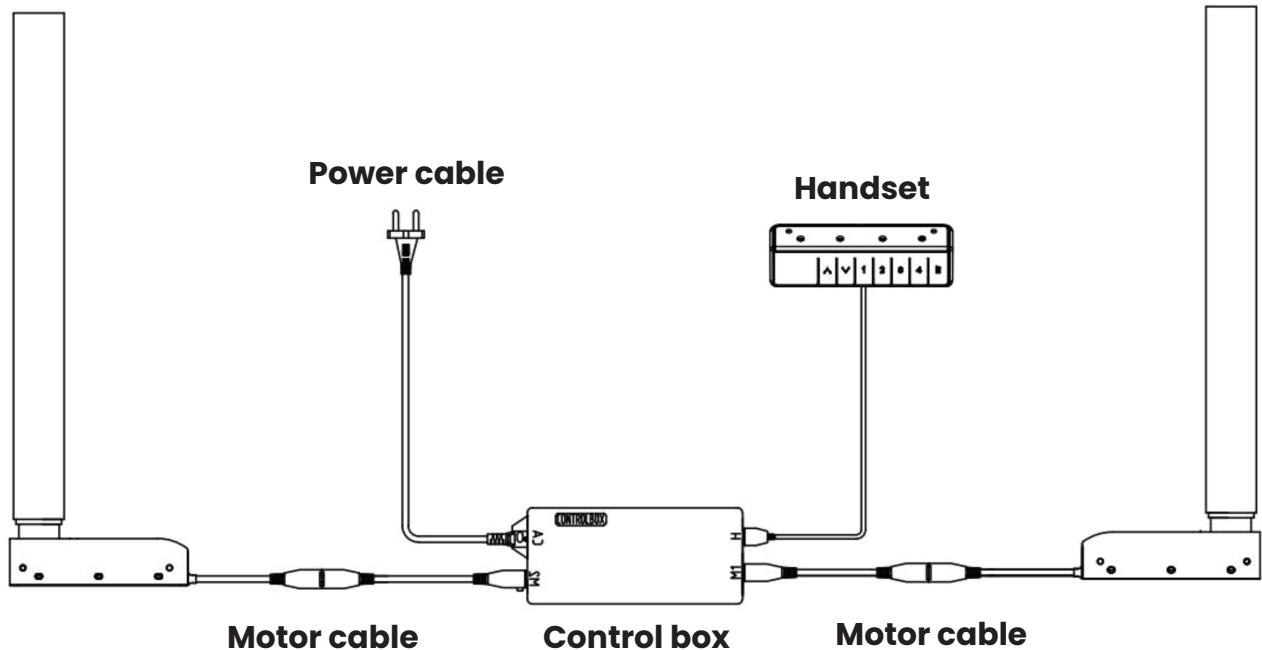

Notice

1. This product must be used under the correct technical parameters.
2. Keep away from liquids, corrosive gases, and dusty environment.
3. Contact us if necessary.

Technical specifications:

Input:	100~240 VAC
Output Power:	24 VDC
Load Capacity:	140 kg
Max.Speed:	30 mm/s
Stroke:	650 mm
Min.Install Dimension:	600 mm
Operation Temperature:	5-40 °C
Duty Cycle:	2 min. on and 18 min. off

ErgoHide